

Waste Water Asbuilt Sheet Index
 NGONGOTAHA

Date: 15/06/2021



U15-1000/45.34

N



53

U15-1000/44.35

U15-1000/46.35

U15-1000/45.36

This data is derived from sources outside the control of Rotorua District Council and is for information only

Rotorua District Council 2006. Facsimile 07 346 3143 Telephone 07 348 4199 email mail@rdc.govt.nz

U15-1000/44.35



U15-1000/43.36

U15-1000/45.36

U15-1000/44.37

This data is derived from sources outside the control of Rotorua District Council and is for information only. All dimensions and levels should be verified by physical location on-site.

Rotorua District Council 2006. Facsimile 07 346 3143 Telephone 07 348 4199 email mail@rdc.govt.nz

U15-1000/45.35



Rotorua District Council 2006. Facsimile 07 346 3143 Telephone 07 348 4199 email mail@rdc.govt.nz

U15-1000/44.36

U15-1000/46.36

45.5

150AC (87.68m)

59

SH005340

8.6 LHB

1.4

150AC (92.24m)

8.5

150AC (55.58m)

U15-1000/45.37

-  Manhole
-  Main line
-  Service Line

WASTEWATER SERVICES
1:2000 @ A3 - (U15-1000/45.36)

This data is derived from sources outside the control of Rotorua District Council and is for information only. All dimensions and levels should be verified by physical location on-site.

U15-1000/42.36



U15-1000/41.37

U15-1000/43.37

U15-1000/42.38

This data is derived from sources outside the control of Rotorua District Council and is for information only

Rotorua District Council 2006. Facsimile 07 346 3143 Telephone 07 348 4199 email mail@rdc.govt.nz

U15-1000/43.36



U15-1000/42.37

U15-1000/44.37

U15-1000/43.38

This data is derived from sources outside the control of Rotorua District Council and is for information only. All dimensions and levels should be verified by physical location on-site.

Rotorua District Council 2006. Facsimile 07 346 3143 Telephone 07 348 4199 email mail@rdc.govt.nz

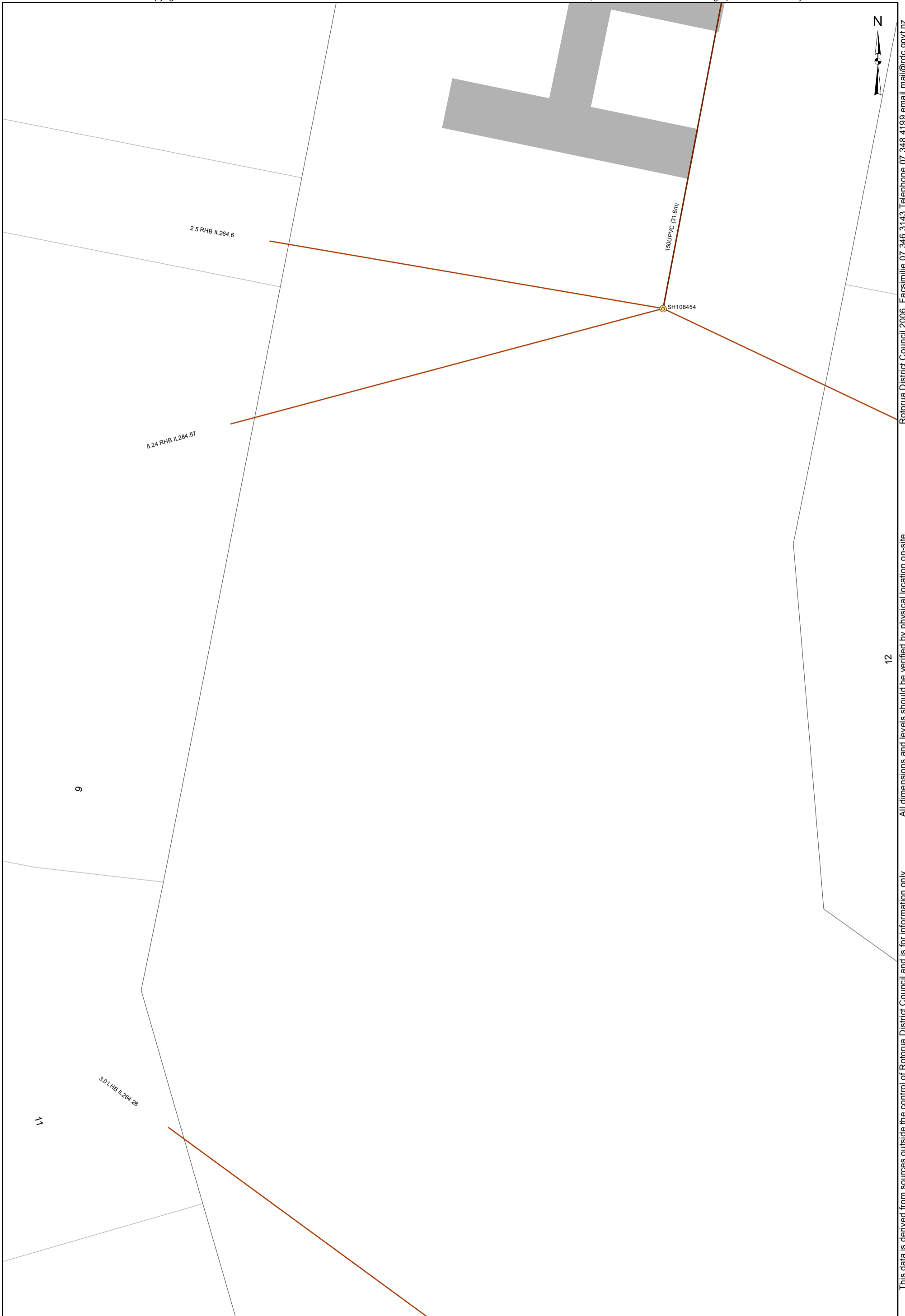

 Manhole
  Main line
 Service Line

WASTEWATER SERVICES
 1:2000 @ A3 - (U15-1000/44.37)

U15-1000/45.36







Rotorua District Council 2006. Facsimile 07 346 3143 Telephone 07 348 4199 email mail@rdc.govt.nz

U15-1000/44.37

U15-1000/46.37

17

U15-1000/45.38

-  Manhole
-  Pump Station
-  Main line
-  Rising main
-  Service Line

WASTEWATER SERVICES
1:2000 @ A3 - (U15-1000/45.37)

This data is derived from sources outside the control of Rotorua District Council and is for information only. All dimensions and levels should be verified by physical location on-site.

225AC (68.15m)

SH000701

225AC (4.6m)

SP000046

300AC (11.45m)

200AC (89.21m)

4.5 LHB

150AC (81.2m)

U15-1000/41.37



U15-1000/40.38

U15-1000/42.38

U15-1000/41.39

This data is derived from sources outside the control of Rotorua District Council and is for information only. All dimensions and levels should be verified by physical location on-site.

Rotorua District Council 2006. Facsimile 07 346 3143 Telephone 07 348 4199 email mail@rdc.govt.nz

U15-1000/42.37



U15-1000/41.38

U15-1000/43.38

U15-1000/42.39

This data is derived from sources outside the control of Rotorua District Council and is for information only. All dimensions and levels should be verified by physical location on-site.

Rotorua District Council 2006. Facsimile 07 346 3143 Telephone 07 348 4199 email mail@rdc.govt.nz

U15-1000/43.37



U15-1000/42.38



U15-1000/44.38

U15-1000/43.39

This data is derived from sources outside the control of Rotorua District Council and is for information only

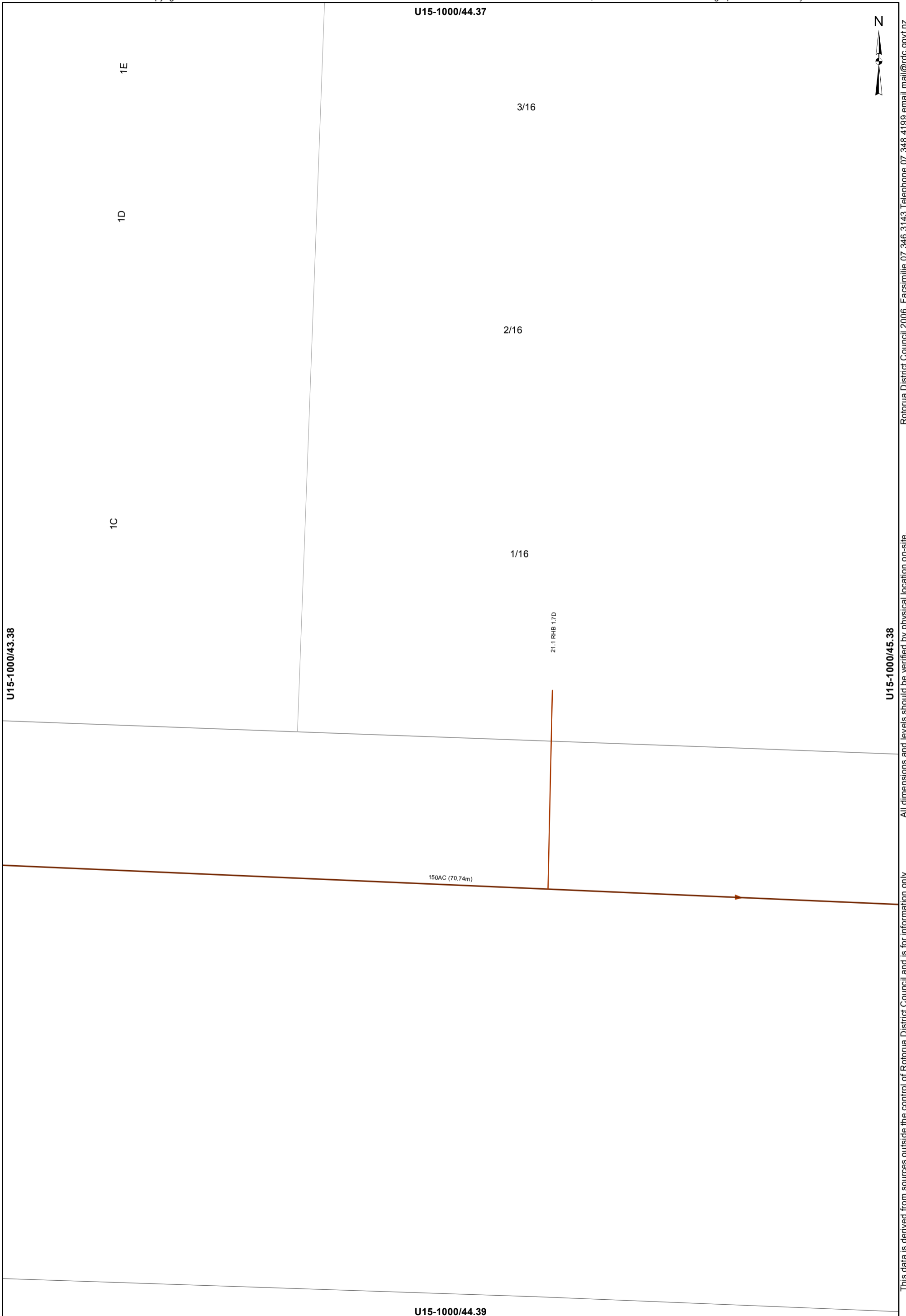
Rotorua District Council 2006. Facsimile 07 346 3143 Telephone 07 348 4199 email mail@rdc.govt.nz



 Main line
 Service Line

WASTEWATER SERVICES
 1:2000 @ A3 - (U15-1000/44.38)

This data is derived from sources outside the control of Rotorua District Council and is for information only

Rotorua District Council 2006. Facsimile 07 346 3143 Telephone 07 348 4199 email mail@rdc.govt.nz

U15-1000/41.38



U15-1000/40.39

U15-1000/42.39

U15-1000/41.40

This data is derived from sources outside the control of Rotorua District Council and is for information only. All dimensions and levels should be verified by physical location on-site.

Rotorua District Council 2006. Facsimile 07 346 3143 Telephone 07 348 4199 email mail@rdc.govt.nz

U15-1000/42.38

N



U15-1000/41.39

U15-1000/43.39

All dimensions and levels should be verified by physical location on-site.

This data is derived from sources outside the control of Rotorua District Council and is for information only

U15-1000/42.40

U15-1000/43.38



Rotorua District Council 2006. Facsimile 07 346 3143 Telephone 07 348 4199 email mail@rdc.govt.nz

U15-1000/42.39

U15-1000/44.39

61

32.6

150AC (47.1m)

SH004105

4.0 RRB

U15-1000/43.40

-  Manhole
-  Main line
-  Service Line

WASTEWATER SERVICES
1:2000 @ A3 - (U15-1000/43.39)

This data is derived from sources outside the control of Rotorua District Council and is for information only. All dimensions and levels should be verified by physical location on-site.

U15-1000/44.38



U15-1000/43.39

U15-1000/45.39

U15-1000/44.40

This data is derived from sources outside the control of Rotorua District Council and is for information only. All dimensions and levels should be verified by physical location on-site.

Rotorua District Council 2006. Facsimile 07 346 3143 Telephone 07 348 4199 email mail@rdc.govt.nz

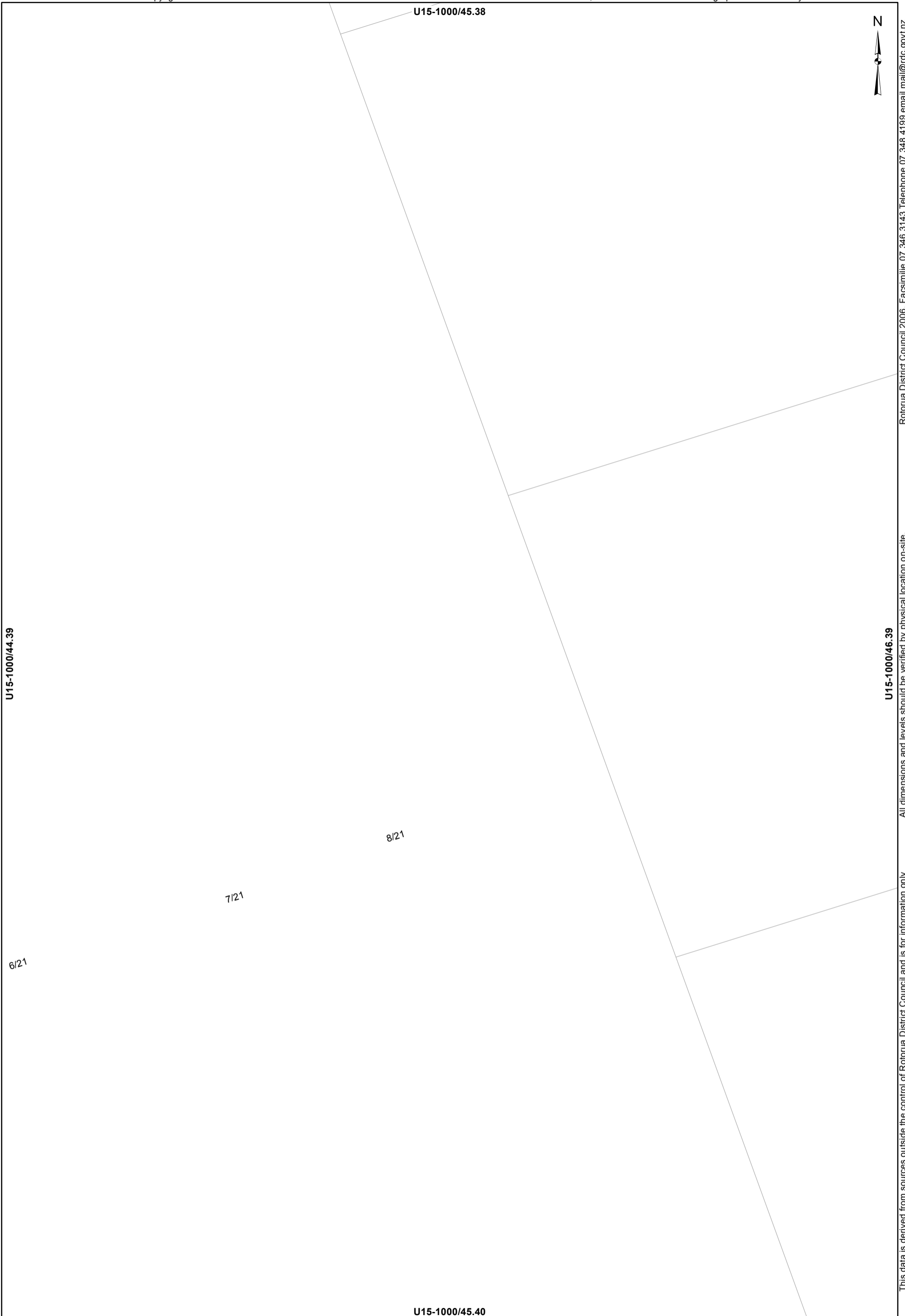

This data is derived from sources outside the control of Rotorua District Council and is for information only. All dimensions and levels should be verified by physical location on-site. Rotorua District Council 2006. Facsimile 07 346 3143 Telephone 07 348 4199 email mail@rdc.govt.nz

U15-1000/46.38



U15-1000/45.39

Lake Rotorua

U15-1000/47.39

U15-1000/46.40

This data is derived from sources outside the control of Rotorua District Council and is for information only

Rotorua District Council 2006. Facsimile 07 346 3143 Telephone 07 348 4199 email mail@rdc.govt.nz

U15-1000/46.39



U15-1000/45.40

U15-1000/47.40

6

U16-1000/46.01

— Service Line

WASTEWATER SERVICES
1:2000 @ A3 - (U15-1000/46.40)

This data is derived from sources outside the control of Rotorua District Council and is for information only

Rotorua District Council 2006. Facsimile 07 346 3143 Telephone 07 348 4199 email mail@rdc.govt.nz

U15-1000/47.39



U15-1000/46.40

Lake Rotorua

U15-1000/48.40

U16-1000/47.01

This data is derived from sources outside the control of Rotorua District Council and is for information only

Rotorua District Council 2006. Facsimile 07 346 3143 Telephone 07 348 4199 email mail@rdc.govt.nz

U15-1000/46.40



U16-1000/45.01

U16-1000/47.01

U16-1000/46.02

This data is derived from sources outside the control of Rotorua District Council and is for information only

Rotorua District Council 2006. Facsimile 07 346 3143 Telephone 07 348 4199 email mail@rdc.govt.nz

U15-1000/47.40



U16-1000/46.01

U16-1000/48.01

U16-1000/47.02

This data is derived from sources outside the control of Rotorua District Council and is for information only. All dimensions and levels should be verified by physical location on-site.

Rotorua District Council 2006. Facsimile 07 346 3143 Telephone 07 348 4199 email mail@rdc.govt.nz

U16-1000/46.01



U16-1000/45.02

U16-1000/47.02

U16-1000/46.03

This data is derived from sources outside the control of Rotorua District Council and is for information only. All dimensions and levels should be verified by physical location on-site.

Rotorua District Council 2006. Facsimile 07 346 3143 Telephone 07 348 4199 email mail@rdc.govt.nz